

NP-M361XC/NP-M311XC/NP-M271XC/ NP-M311W+/NP-M271W+ 快速设置指南

步骤

1

将电脑与投影机相连。

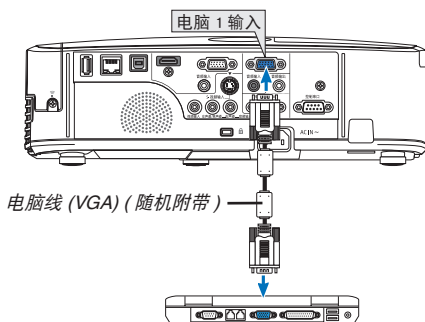

步骤

2

连接随机附带的电源线。

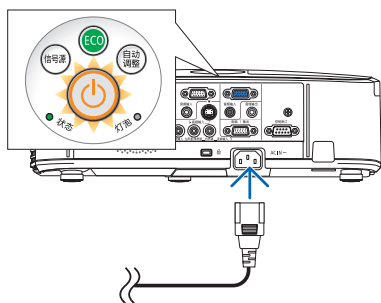

步骤

3

将镜头盖滑至左边使镜头打开。

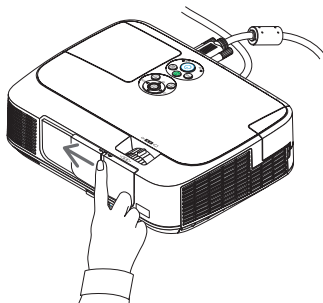

步骤

4

开启投影机。

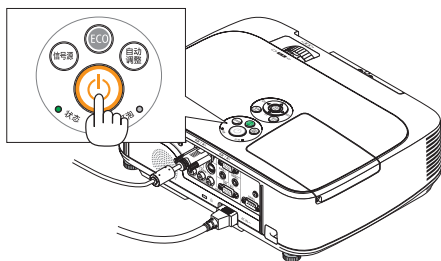

步骤

5

选择信号源。

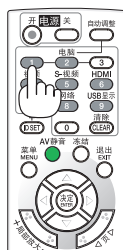
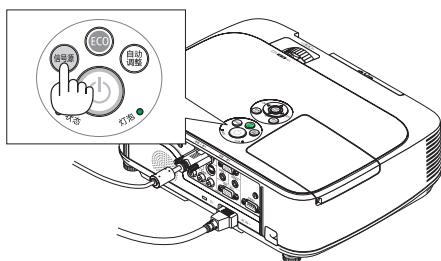

提示:

按下自动调整键自动优化电脑影像。

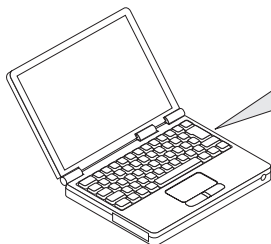
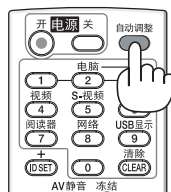

Fn + F1 - F12

(→ 请参阅用户手册第 23, 104, 124 页)

调整图片尺寸和位置。

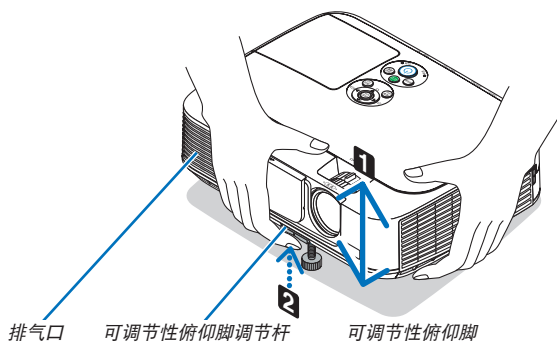

调整俯仰脚

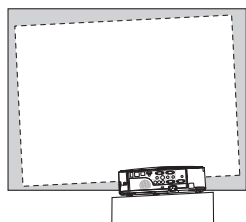
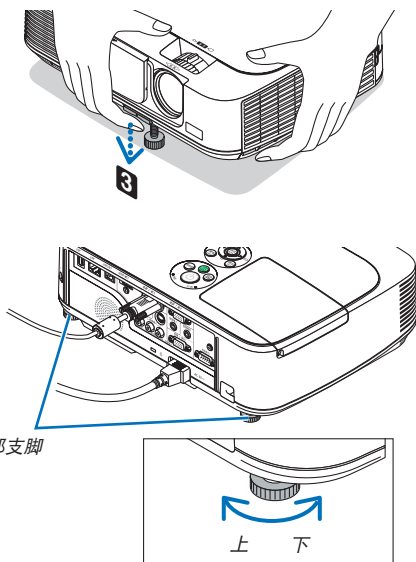

变焦

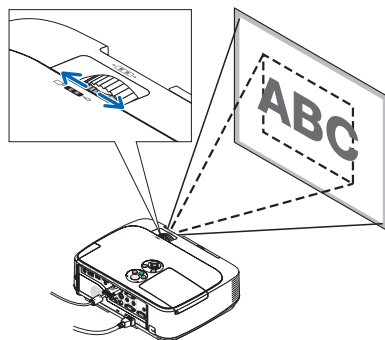

聚焦

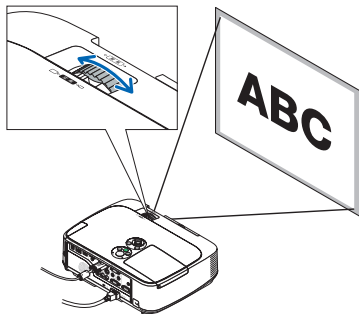

出厂时，自动修正梯形失真功能处于开启状态。

在无菜单显示的状态下，您也可使用 ▲ 或 ▼ 键手动执行梯形修正。

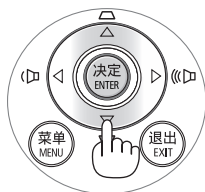

(→ 请参阅用户手册第 21 页)

步骤 7

1. 按两次电源 (关) 键。

灯泡将熄灭。电源指示灯的颜色将变为橙色，并且状态指示灯亮绿色。这表明投影机正处于待机模式。

2. 将镜头盖滑至右边使其盖上镜头。

3. 断开所有连接线。

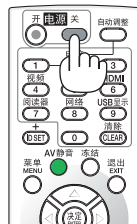
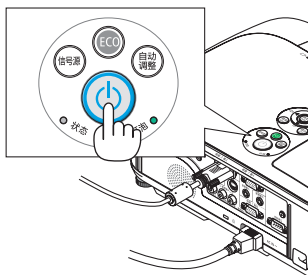

(→ 请参阅用户手册第 24 页)