

LT75Z Quick Connect Guide

NEC

Connections

Step 1

Connect the supplied 15pin-15pin signal cable.

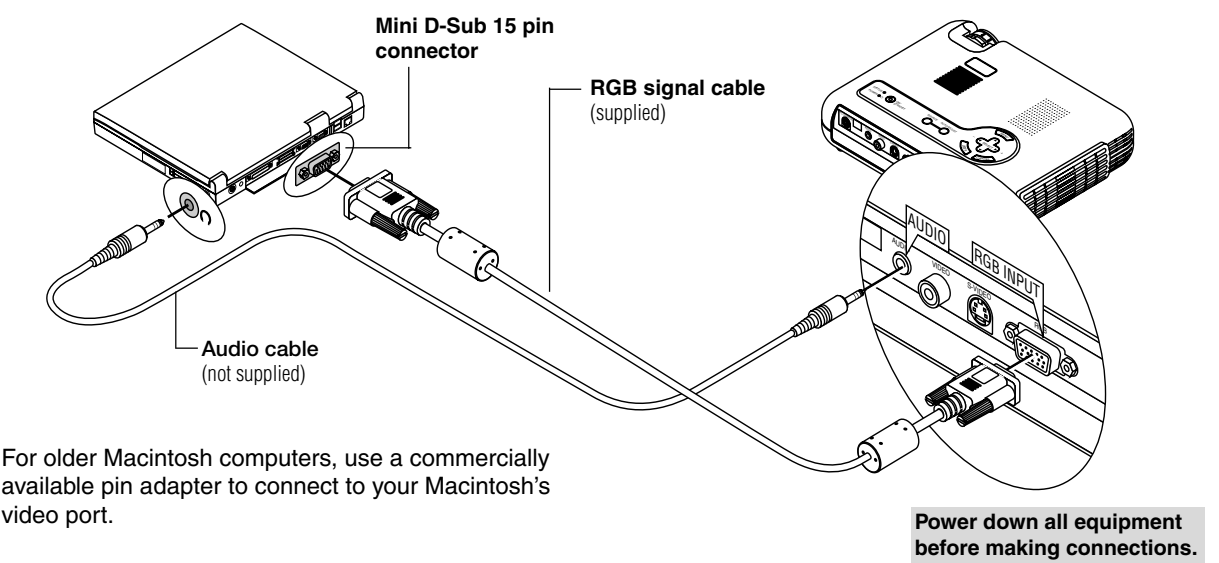

Step 2

Connect the supplied power cable.

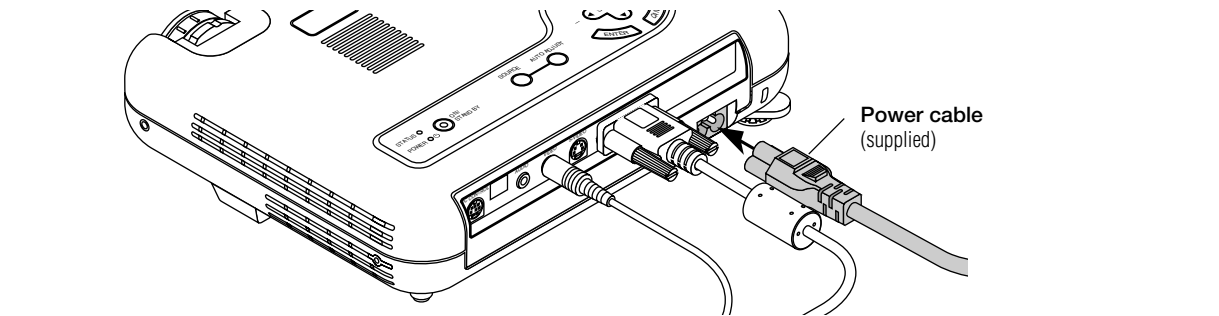

Step 3

Turn on the Projector.

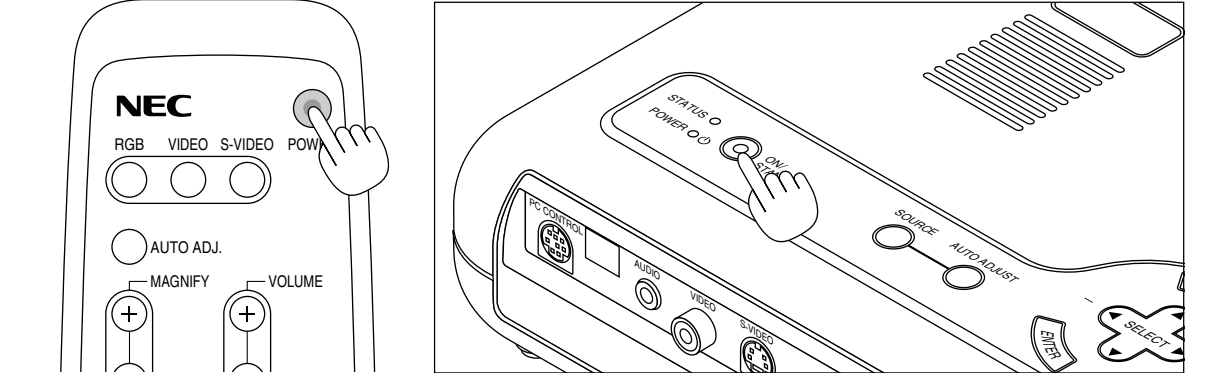

Step 4

Set up the Projector.

To adjust the projector's focus and zoom use the Focus ring and the Zoom ring on the lens.

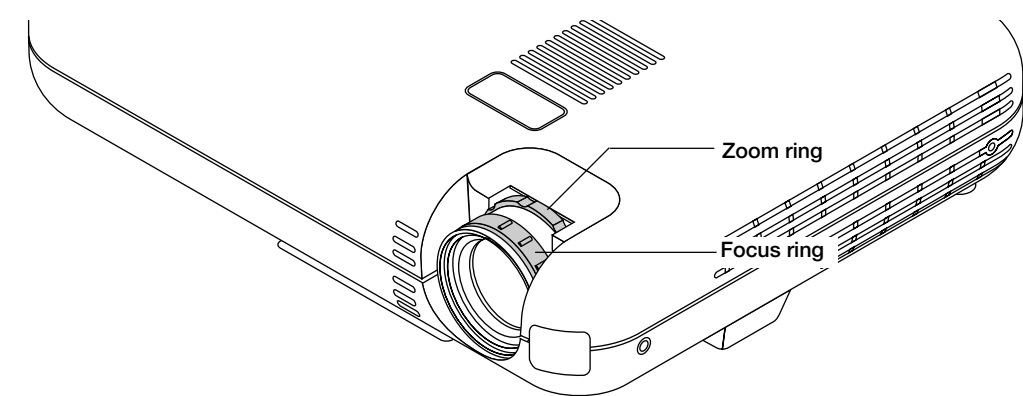

Adjusting the Tilt Foot.

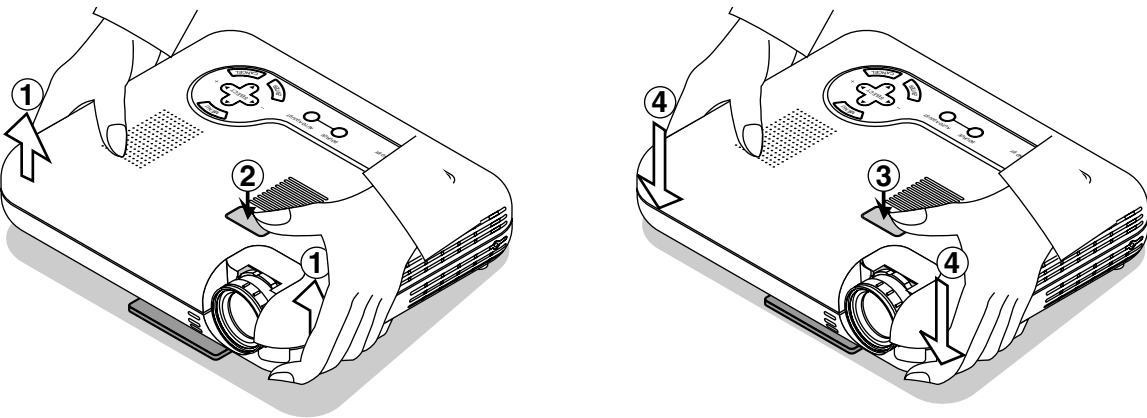

1. Lift the front edge of the projector.
 2. Press the Tilt button on the top of the projector to extend the Adjustable Tilt Foot.
 3. Press and hold the Tilt button.
 4. Lower the front edge of the projector to the desired height and release the Tilt button to lock the Adjustable Tilt Foot.
- If the projected image does not appear square to the screen then use keystone correction for proper adjustment. See page 27 of the supplied user's manual.

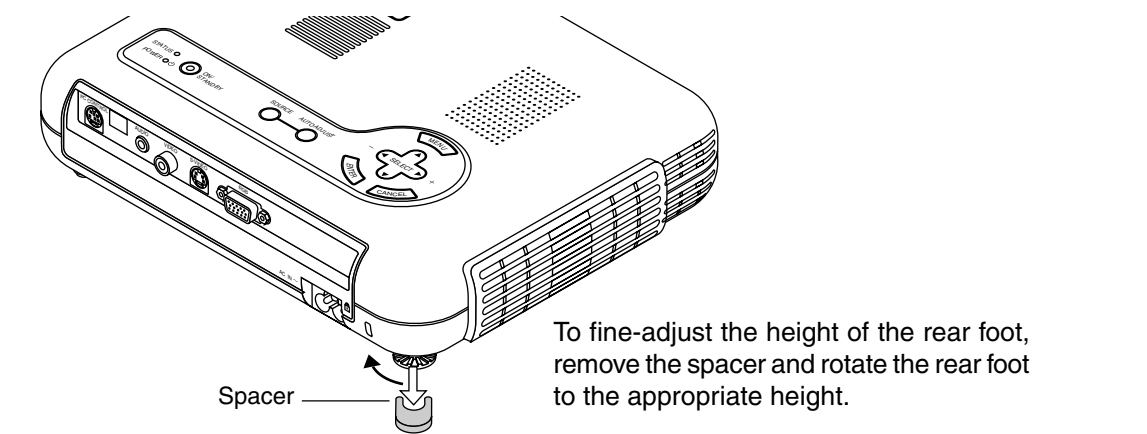

Remote Control Features

1. Infrared Transmitter
Direct the remote control toward the remote sensor on the projector cabinet.

2. Power Button
If power is applied, you can use this button to turn your projector on and off.

NOTE: To turn off the projector, press and hold the POWER button for a minimum of two seconds.

3. Source Buttons
Press to select a video source.

4. Auto Adjust Button
Use this button to adjust Position-H/V and Pixel Clock/Phase for an optimal picture. Some signals may not be displayed correctly, or in some cases it may take some time for a source to switch between sources.

5. Magnify Buttons
Use the (+) or (-) button to adjust the image size up to 400%.

6. Volume Buttons
Press (+) to increase the volume and (-) to decrease it.

7. Picture Button
Press this button to display the Picture adjustment window. Each time this button is pressed, the current picture adjustment item will change as follows:

► Brightness ► Contrast ► Color ► Hue ► Sharpness

Unavailable items will be skipped.

8. Freeze Button
This button will freeze a picture. Press again to resume motion.

9. Mute Button
This button turns off the image and sound for a short period of time. Press again to restore the image and sound.

10. Aspect Button
Press this button to display the Aspect Ratio select window. Each time this button is pressed, the current aspect ratio will change as follows:

► Normal ► Zoom ► Wide Zoom ► Cinema

You can also select the aspect ratio by using the Select ◀ or ▶ button. If no adjustments are performed within 3 seconds, the Aspect Ratio select window will disappear. (See also page E-28.)

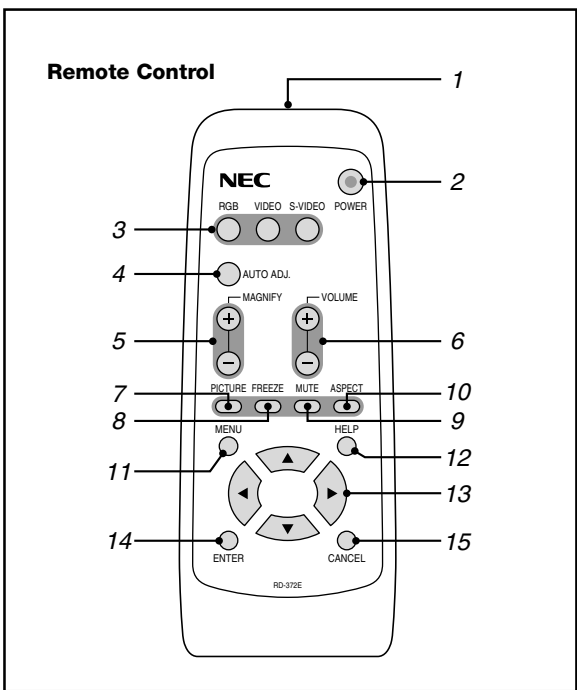

11. Menu Button
Displays the menu.

12. Help Button
Provides information about the current signal and the status of the projector.

13. Select (▲▼◀▶) Buttons
▲▼ : Use these buttons to select the menu of the item you wish to adjust.
◀▶ : Use these buttons to change the level of a selected menu item.

14. Enter Button
Executes your menu selection and activates items selected from the menu.

15. Cancel Button
Press this button to exit the menu. While you are in the adjustment or setting menu, pressing this button will return to the previous menu.

NOTE: To turn off the projector, press and hold the Power "ON/STAND BY" button for a minimum of two seconds.

Menu Tree

Basic/Advanced Menu

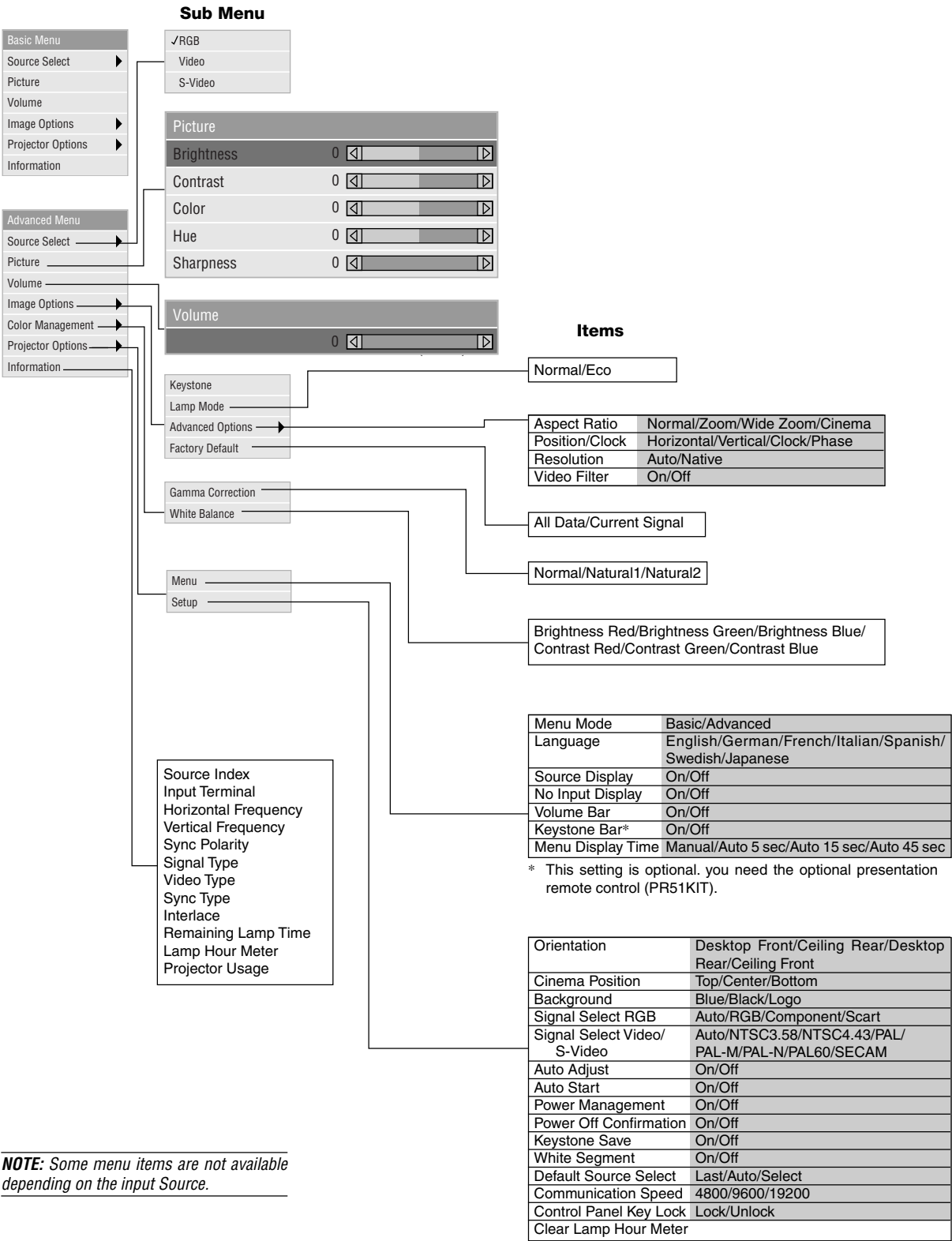

NOTE: Some menu items are not available depending on the input Source.

Troubleshooting

This section helps you resolve problems you may encounter while setting up or using the projector.

Power/Status Light Messages

Condition	Power Indicator	Status Indicator	Note
Standby	Steady orange	–	–
Cooling down	Blinking green	–	Blinks green for 90 seconds
Lamp in Normal mode	Steady green	–	–
Lamp in Eco mode	Steady green	Steady green	–
Retrying to turn on lamp	Steady green	Blinking orange	The projector retries 3 times at an interval of 15 sec for max. 45 sec)
One minute after lamp is turned on	Blinking green	No light in Normal mode / Steady green in Eco mode	–
Lamp has reached its end of life (Normal: 1000 hours or over) (Eco: 1500 hours or over)	Steady green	Steady red	Message appears on screen during 1000-1100 hours (1500-1600 hours: Eco mode) of lamp usage. The projector reaches its end of life. Please replace the lamp as soon as possible
Lamp life has reached its end of life (Normal: 1100 hours or over) (Eco: 1600 hours or over)	Steady orange	Steady red	The projector is in standby mode and cannot be turned on.
Lamp cover error	Steady orange	Blinking red (1 sec interval)	The projector is in standby mode and cannot be turned on.
Temperature error	Steady orange	Blinking red (4 sec interval)	The projector is in standby mode and cannot be turned on.
Fan error	Steady orange	Blinking red (8 sec interval)	The projector is in standby mode and cannot be turned on.
Lamp error	Steady orange	Blinking red (12 sec interval)	The projector is in standby mode and cannot be turned on.

Common Problems & Solutions

Problem	Check These Items
Does not turn on	<ul style="list-style-type: none">Check that the power cable is plugged in and that the power button on the projector cabinet or the remote control is on.Ensure that the lamp cover is installed correctly. See page E-34.Check to see if the projector has overheated or the lamp usage exceeds 1100 hours. If there is insufficient ventilation around the projector or if the room where you're presenting is particularly warm, move the projector to a cooler location.
No picture	<ul style="list-style-type: none">Use the menu to select your source (Video, S-Video or RGB). See page E-27.Ensure your cables are connected properly.Use menus to adjust the brightness and contrast. See page E-27.Remove the lens cap.Reset the settings or adjustments to factory preset levels using the Factory Default in the Adjustment Menu. See page E-29.
Image isn't square to the screen	<ul style="list-style-type: none">Reposition the projector to improve its angle to the screen. See page E-22.Use the Keystone in the Adjustment Menu to correct the trapezoid distortion. See page E-27.
Picture is blurred	<ul style="list-style-type: none">Adjust the focus. See page E-22.Reposition the projector to improve its angle to the screen. See page E-22.Ensure that the distance between the projector and screen is within the adjustment range of the lens. See page E-14.
Image is scrolling vertically, horizontally or both	<ul style="list-style-type: none">Use menus or Source button on the remote control or the cabinet to select the source you want to input.
Remote control does not work	<ul style="list-style-type: none">Install new batteries. See page E-13.Make sure there are no obstacles between you and the projector.Stand within 22 feet (7 m) of the projector. See page E-13.
Status indicator is lit or blinking	<ul style="list-style-type: none">See the Status Light messages above.
Cross color in RGB mode	<ul style="list-style-type: none">If Auto Adjust is off, turn it on. If Auto Adjust is on, turn it off and balance the image with the Position/Clock in the Image Options. See page E-29 or E-32.